



# Sea Queen Park

EXCLUSIVE 1 & 2 BHK

AT TALOJA-GHOT





# A NEW WAVE OF LIVING.





# EVERYTHING YOU NEED. ALL RIGHT HERE

EXCLUSIVE 1 & 2 BHK

It's simply great when it comes to connectivity, quality or well being you can be assured that your decision to move into **Sea Queen park** is definitely worth every bit !



## AMENITIES



Kids Play Area



Yoga & Meditation Deck



Landscaping



Ample Space for Parking



Mechanical Gym



CCTV Surveillance



Senior Citizen Zone



Gated security





Artistic Impression



Artistic Impression

**Unwind.  
De-stress.  
Breathe easy.**

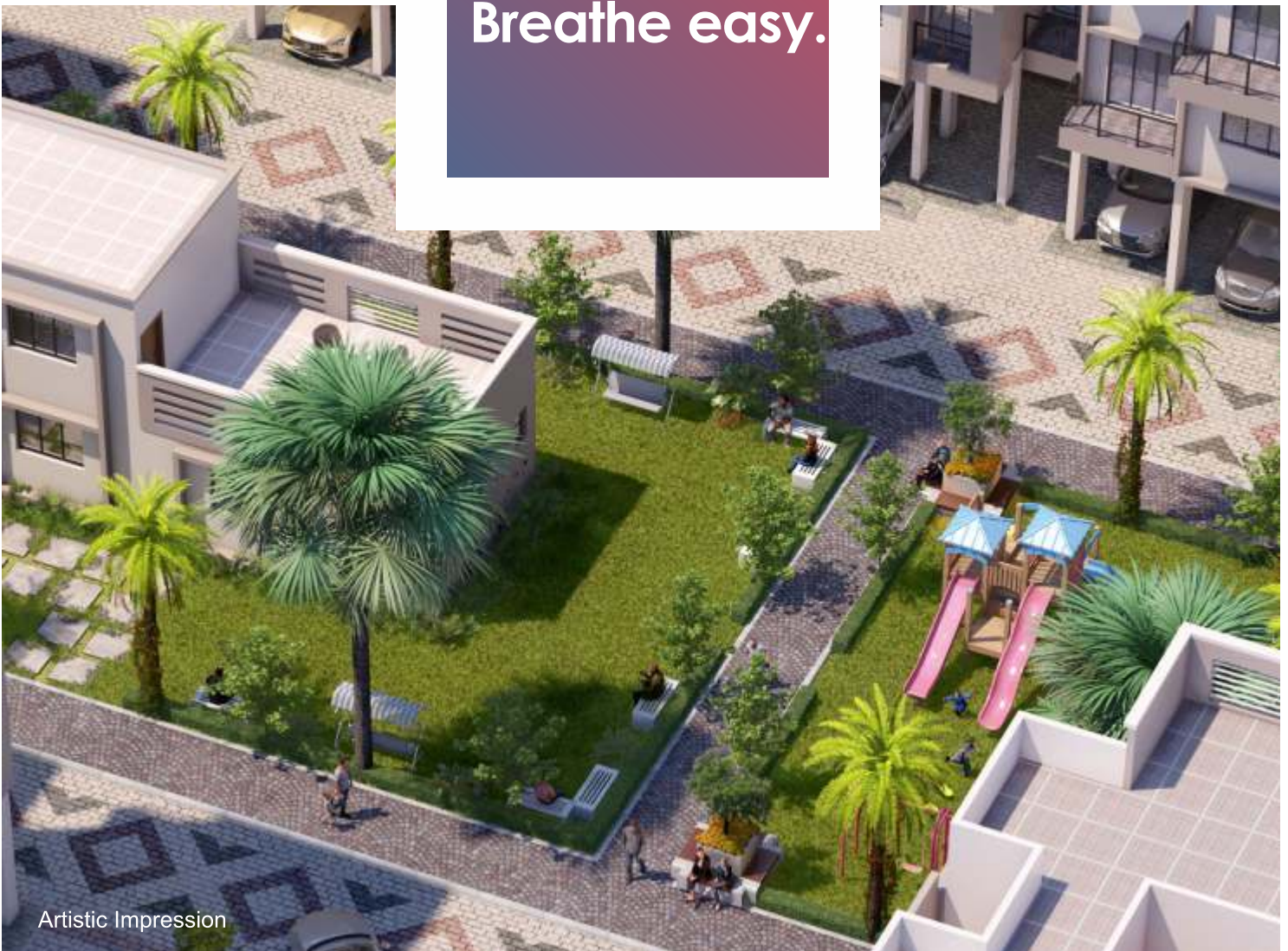

Artistic Impression







## LOCATION ADVANTAGES



### CONNECTIVITY

- Taloja Railway Station - 10 Min
- Pendher Metro Station - 5 Min
- Kharghar Station - 20 min
- Sion - Panvel Highway - 20 Min
- Navi Mumbai International Airport - 30 Min



### HEALTHCARE

- Shri Sathya Sai Navjeevan Hospital - 15 Min
- Tata Hospital - 15 Min
- Polaris Hospital - 20 Min
- MGM Hospital - 30 Min
- MITR - 35 Mins



### MAJOR DEVELOPMENTS

- Proposed BKC 2 - 15 Min
- 18 Hole Golf Course - 15 Min
- Central Park- 15 Min
- ISKCON Temple - 15 Min



### EDUCATION

- Apeejay School - 15 Min
- DAV International School - 15 Min
- Vibgyor High School - 15 Min
- ITM - 20 Min
- Shri Ramsheth Thakur College - 15 Min
- NMISM - 20 Min



### MALL & ENTERTAINMENT

- Little World Mall - 20 Min
- Seawoods Grand Central Mall - 35 Mins

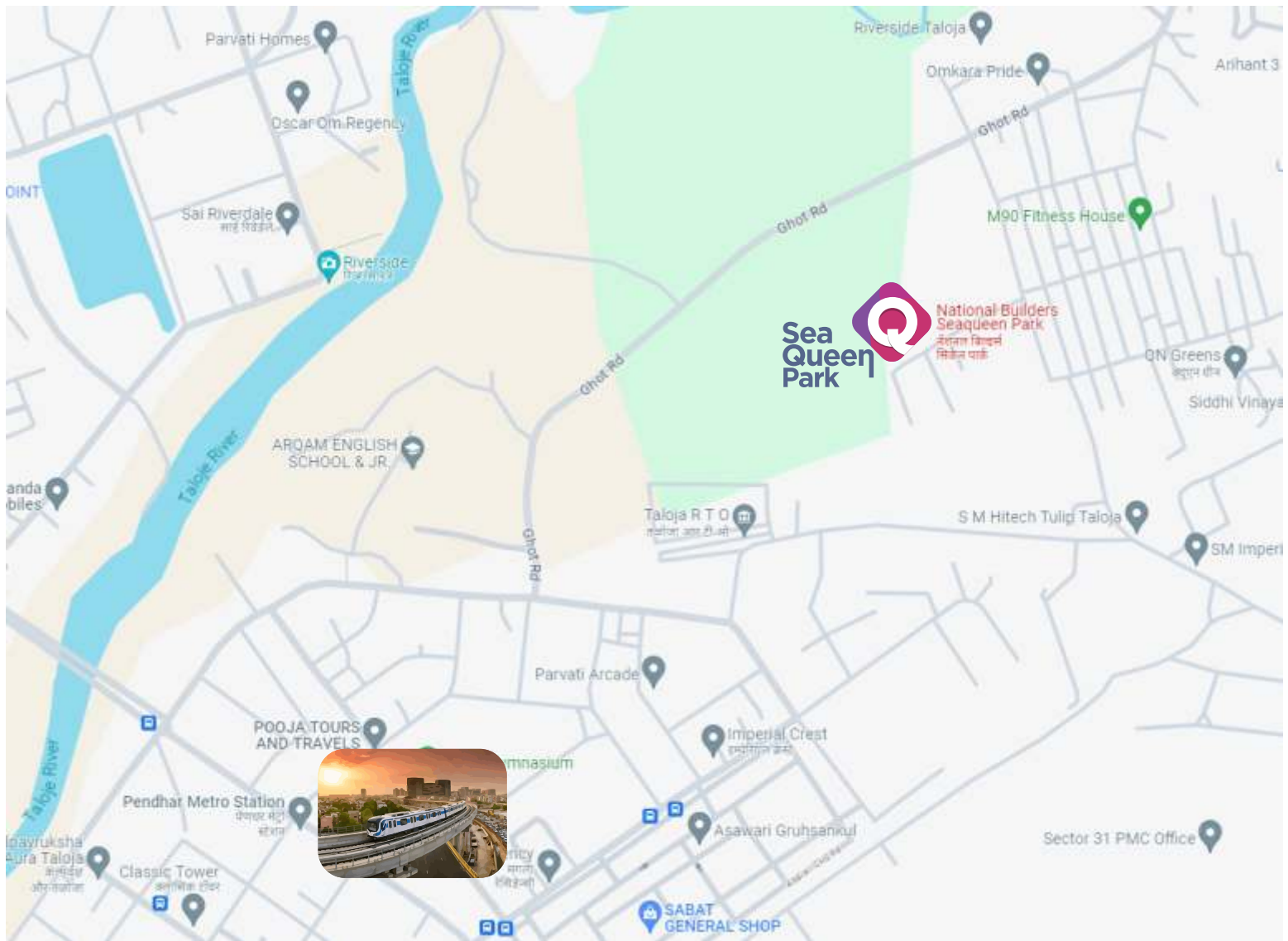

Project By



Corporate Office:-

**[www.mayaproperties.in](http://www.mayaproperties.in)**

**CALL US FOR BOOKING**



**+91 70453 17389**



**SEA QUEEN PARK**

**Survey No.109/5, 112/6, 112/7, At Taloja Majkur, Ghot, Panvel**

The Project is registered with MahaRERA Registration No.**P52000018773**; Available at <http://maharera.mahaonline.gov.in>

**DISCLAIMER:** This is not an offer, invitation to offer, and/or commitment of any nature and the content hereof is not and should not be construed as an offer/invitation to offer/contract or any intention thereof and/or any disclosure under any statute of any nature whatsoever. All plans, designs, images, renders, specification, dimensions, facilities and other details herein are artistic impressions and stock images and purely for illustrative and representational purpose and indicative in nature and the intended recipient should note that these are to be treated as purely provisional and informative and as such only tentative subject to approval from respective authorities. No warranty is expressly or impliedly given that the completed development will comply in any degree with such artist's impression as depicted. The photographs contained herein are stock/standard photography and may have been taken at location other than the project site and are used to indicate a conceptual lifestyles. The actual images/views have been enhanced/touched up/airbrushed for visual, illustrative and creative purposes. All specifications of the flat/project shall be as per the final agreement between the parties. Recipients are advised to use their discretion in relying on the information/amenities described/described/shown herein. The visitor/recipient is aware that the furniture, fittings and fixtures displayed in the sample/show flat/ show residence at the sales pavilion /brochures are only for the purpose of showcasing the flats and we shall not be liable, required and/or obliged to provide any further, fittings as displayed in the sample/show flat/show residence at the sales pavilion/brochures. The color shades of wall, tiles etc., are for representational purpose and will vary in planning and designing and upon actual construction. The render for internal spaces is only to serve as an example of the suggested space management and possible utilization of space. Any party desirous/interested in the project need to enter into formal legal agreement for sale and the development/ transaction shall be governed by the terms and conditions of the said agreement for sale. \*Government taxes/ duties/ levies as applicable. \*Terms and Conditions apply.